



Castellated Panel - CP12

Overview

Castellated panel retention system for direct application on existing sub-floors and offering pipe encapsulation within a layer of self-levelling screed. The 15mm thick 'On-base' panel design provides a diverse 12mm pipe matrix layout to maximise performance and floor area coverage. Adjoining panels are interlocked with a simple clip system to maintain pipe alignment.

Application

Ideal for both new build and renovation projects, the low-profile self-adhesive panel system can be installed on solid and timber suspended floors. Multiple pipe layouts can be accommodated due to the 75/150mm grid retention design. Capable of producing a high output system using low water temperatures making it ideal for both low and high temperature heat sources.

Nominal Thickness (excluding floor finish)
Typically 15mm to 18mm depending on sub-floor, screed specification and floor finish.

Features and Benefits

- 'On-Base' floor construction
- Low-profile system
- High heating output
- Flexible pipe matrix
- Ideal for low and high temperature heat sources

System Performance

- ★★★★★ Heating Output
- ★★★★★ Response Time
- ★★★★★ Water Temperature

Options Available

- Pre-bonded XPS300 insulation
- 12mm feed pipe clip rail
- Edge insulation
- Levelling Compound
- Pipe decoiler

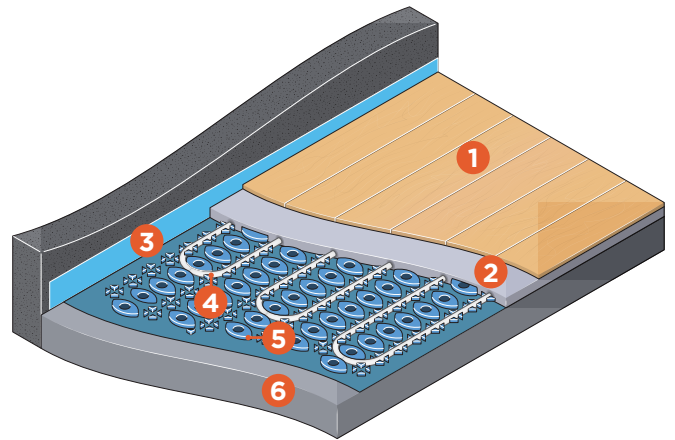

Typical Isometric

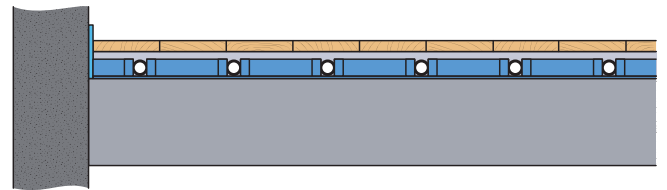

Typical Cross-section

Typical Floor Construction

- 1 Floor covering
- 2 Self-levelling compound / renovation screed
- 3 Edge insulation
- 4 Underfloor heating pipe
- 5 Castellated panel with self-adhesive backing
- 6 Subfloor